

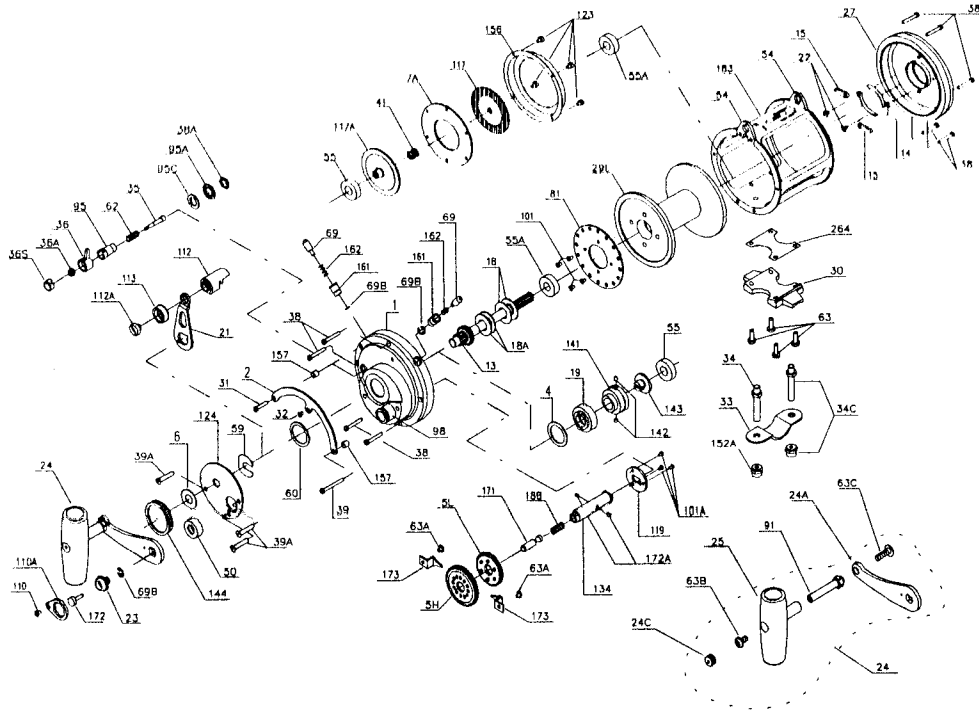

PARTS AND PRICE LIST FOR INTERNATIONAL II 50S AND 50SW



Key No.	Part No.	Description	Price	Key No.	Part No.	Description	Price
1	001 050SN	Right-Side Plate Assembly	\$99.50	55A	055 080	Ball Bearing (2 req.)	\$16.00
2	002 050	Quadrant	7.05	59	059 050	Slotted Washer	.80
4	004 050	Cam Thrust Washer	.90	60	060 050	Backing Washer	.90
5H	005 050HS	Main Gear High-Speed	17.25	62	062 050	Click Spring	.90
5L	005 050LS	Main Gear Low-Speed	18.75	63	063 030T	Stand Screw (4 req.)	.80
6	006 155	Spacer Washer	.60	63A	063 349	Gear Retainer Screw (2 req.)	.80
7A	007A050S	Floating Drag Washer	13.25	63B	63 050	Screw	.90
13	013 050S	Pinion Gear	35.00	63C	63A050	Long Screw	1.25
	013 050SW	Pinion Gear	39.00	69	069 050	Locating Pin	1.20
14	014 050	Dog Spring (2 req.)	1.00	69B	069B050	Retaining Ring (3 req.)	.80
15	015 050	Dog (2 req.)	.80	81	081 050	Ratchet	5.15
18	018 050W	Disc Clutch Spring (2 req.)	.90	91	091N050	Handle Rivet	2.50
18A	018 050TW	Disc Clutch Spring (2 req.)	.90	95	095 080	Click Tongue Bushing	2.35
18B	018 349	Gear Stud Spring	.45	95A	095A020	Click Bushing Washer	.65
19	019 050W	Eccentric Cam	13.00	95B	095A050	Click Bushing Washer	.65
21	021 050S	Eccentric Lever	6.50	98	098 050SN	Bridge Bushing	5.10
22	022 109	Dog Spring Screw	.55	101	101 030	Ratchet Plate Screw (4 req.)	.45
23	023 050S	Handle Screw	3.70	101A	101 050S	Coupling Plate Screw (3 req.)	.45
24	024 050T	Handle Complete	17.00	110	110 050	Handle Lock Screw	.50
24A	024 050T-1	Handle Blank Only	6.40	110A	110A050	Handle Locking Plate	2.40
24C	024C050	Handle Knob Cap	1.25	112	112 050	Eccentric Lever Knob	16.25
25	025 050	Handle Knob	6.00	112A	112A050	Eccentric Screw	.90
27	027 050T	L.S. Plate Assembly	73.00	113	113 050	Eccentric Lever Cap	3.95
29L	029L050S	Spool	88.50	117	117 050S	Outer Drive Plate Assembly	16.25
	029L050SW	Spool	98.00	117A	117A050S	Inner Drive Plate Assembly	16.25
30	030 050T	Stand	21.00	119	119 030S	Coupling Plate	1.10
31	031T020	Short Quadrant Screw	.55	123	123 050	Drag Cover Screw (4 req.)	.45
32	032 014CH	Center Quadrant Screw	.40	124	125 050S	Cam Housing	9.00
33	033 114	Rod Clamp	5.30	*	124 050	Bridge Cover	5.90
*	*033R114	Ringed Rod Clamp (Optional)	9.29	134	134 050S	Gear Stud	9.50
34	034 050T	Clamp Screw (2 req.)	2.05	141	141 050	Cam Follower	5.75
34C	034C050T	Rod Clamp Screw w/Nut	3.40	142	142 050	Cam Follower Pin (2 req.)	.60
35	035 080N	Click Tongue	3.25	143	143 050	Adjusting Screw	4.25
36	036 050	Click Button	7.00	144	144 050	Preset Knob	6.95
36A	036 700	Click Button Nut	.90	152A	152A050T	Rod Clamp Acorn Nut (2 req.)	1.35
36S	036S080ST	Click Button Cap	.40	156	156 050	Drag Cover	5.05
38	038T050	Frame Screw (9 req.)	.50	157	157 050	Quadrant Spacer Bushing (2 req.)	.60
38A	038 710	Click Bushing Nut	.50	161	161 050	Locating Pin Bushing (2 req.)	1.20
39	039 050	Long Quadrant Screw	1.00	162	162 050	Locating Pin Spring (2 req.)	.50
39A	039A080S	Bridge Cover Screw (3 req.)	.45	171	171 050S	Plunger	3.00
41	041 050S	L.S. Bearing Spring	.90	172	172 050S	Plunger Cap	2.70
50	050 025	Gear Stud Cover	2.00	172A	172A050S	Plunger Pin (2 req.)	.60
54	054 050T	Harness Lug (2 req.)	2.90	173	173 050S	Gear Retainer (2 req.)	1.35
55	055 050	Ball Bearing (2 req.)	15.00	183	183 050S	Tube Frame	96.25
NOTE:	3-50S	Bridge Use For OLD STYLE R.S. Plate	17.25	183 050SW	Tube Frame	105.50	
				264	264 030T	Stand Gasket	1.60